



MEMORANDUM

TO: Mr. Marc Levun | IN-N-OUT

FROM: Giancarlo Ganddini, PE, PTP | GANDDINI GROUP, INC.

DATE: May 26, 2022

SUBJECT: Drive Through Queuing Analysis for In-N-Out at 560 West Huntington Drive (Monrovia)
Project No. 19475

The purpose of this memorandum is to document anticipated drive through lane stacking needs for the proposed project based on drive through lane queue surveys observed at existing In-N-Out restaurants. We trust this analysis will aid you and the City of Monrovia in assessing the project.

PROJECT DESCRIPTION

The approximately 1.3-acre project site is located at 560 West Huntington Drive within the existing Huntington Oaks Center in the City of Monrovia, California.

The project site is currently developed with a 10,927-square-foot vacant building previously occupied by a sit-down restaurant (Black Angus). The proposed project involves redevelopment of the existing site and construction of a new 3,879 square foot In-N-Out Burger restaurant with drive through window. The project site plan is provided in Attachment A.

As shown on the project site plan, the project is proposing a dual-lane drive through layout that merges into a one lane prior to a single service point for taking orders at the menu board approximately located at the 9th vehicle position from the pick-up window. The proposed In-N-Out drive through layout will provide storage capacity for a total of approximately 26 vehicles.

DRIVE THROUGH LANE QUEUE SURVEYS

To evaluate adequacy of the proposed drive through lane, this analysis compiled data of actual vehicular queues observed within the drive through lanes at existing In-N-Out Burger restaurants throughout Southern California. Queue survey data used for this analysis was collected at the following locations:

Survey Location	Weekday Count Dates	Weekend Count Dates
Corona - 2305 Compton Avenue, Corona, CA 92881	12/4-8/2017	12/2-3/2017
Highland - 28009 Greenspot Road, Highland, CA 92346	12/4-8/2017	12/2-3/2017
Indio - 82043 Highway 111, Indio, CA 92201	6/27/2019	6/22/2019
La Quinta - 78611 Highway 111, La Quinta, CA 92253	6/27/2019	6/22/2019
Long Beach - 6391 E Pacific Coast Hwy, Long Beach, CA 90803	5/16/2012	5/19/2012
Los Angeles - 9149 S Sepulveda Blvd, Los Angeles, CA 90045	5/16/2012	5/19/2012
Thousand Palms - 72265 Varner Rd, Thousand Palms, CA 92276	6/27/2019	6/22/2019

Drive through lane queues at the Corona and Highland locations were counted over multiple weekdays and weekend days from 10:30 AM to 1:00 AM. Weekday counts were conducted on Monday, December 4, 2017 through Friday, December 8, 2017 and weekend counts were conducted on Saturday, December 2, 2017 and Sunday, December 3, 2017. To provide a conservative assessment, the queue values for the greatest queue observed during the specified time period on any given weekday or weekend day during which the counts were collected. The drive through queue survey sheets are provided in Attachment B.

Tables 1 and 2 summarize the drive through lane queue survey results for weekdays and weekends, respectively. As shown in Table 1, the peak drive through lane queue ranged from 15 to 24 vehicles on weekdays. The average peak queue observed on weekdays is equal to 20 vehicles and the 85th-percentile queue is equal to 23 vehicles. As shown in Table 2, the peak drive through lane queue ranged from 16 to 25 vehicles on weekends. The average peak queue observed on weekends is equal to 22 vehicles and the 85th-percentile queue is equal to 24 vehicles.

RECOMMENDED DESIGN VALUE

In statistics, the 85th-percentile describes the value at which 85 percent of the samples are distributed at or below. Assuming the survey sample is representative of future In-N-Out locations, design of the drive through lane for the 85th-percentile queue is expected to accommodate the peak queue for 85 percent of sites. Whereas designing for the average peak could result in drive through queue overflow at roughly one out of two locations, use of the 85th-percentile is intended to provide a more conservative approach without unnecessarily over-designing the drive through lane for a significant majority of sites.

Based on the 85th-percentile peak queue, it is recommended that the proposed project provide drive through lane storage capacity for a minimum of 24 vehicles.

CONCLUSION

The proposed In-N-Out drive through lane with queuing capacity for approximately 26 vehicles is forecast to provide adequate storage capacity within the drive through layout based on an 85th-percentile peak queue of 24 vehicles observed from a sample of comparable In-N-Out restaurants.

We appreciate the opportunity to assist with this project. Should you have any questions or comments, please contact me at (714) 795-3100.

Table 1
Weekday Drive Through Queue Survey Summary

Time	Peak Queue Observed within 15-Minute Increment								85th- %ile
	Corona	Highland	Indio	La Quinta	Long Beach	Los Angeles	Thousand Palms	Average	
LUNCH									
11:00 AM	17	14	5	8	3	6	15	10	15
11:15 AM	17	17	7	7	6	12	16	12	17
11:30 AM	16	16	12	12	7	16	18	14	16
11:45 AM	17	17	12	13	14	19	14	15	17
12:00 PM	23	19	12	21	15	20	17	18	21
12:15 PM	24	21	10	22	15	18	16	18	22
12:30 PM	23	21	9	19	13	21	16	17	21
12:45 PM	17	20	12	18	8	19	20	16	20
1:00 PM	16	19	16	18	12	22	10	16	19
1:15 PM	18	14	12	20	13	21	12	16	20
1:30 PM	17	16	10	18	8	20	13	15	18
1:45 PM	15	18	8	16	7	20	10	13	18
2:00 PM	16	17	7	14	8	21	19	15	19
DINNER									
4:00 PM	17	15	7	15	6	17	7	12	17
4:15 PM	16	19	4	21	5	15	10	13	19
4:30 PM	17	17	7	20	3	12	9	12	17
4:45 PM	16	18	7	20	6	10	11	13	18
5:00 PM	23	19	6	22	5	9	10	13	22
5:15 PM	23	19	12	18	7	14	14	15	19
5:30 PM	23	19	10	21	7	17	13	16	21
5:45 PM	18	21	9	19	5	19	9	14	19
6:00 PM	23	23	10	16	12	20	12	17	23
6:15 PM	24	22	8	22	7	19	16	17	22
6:30 PM	24	19	11	23	10	20	18	18	23
6:45 PM	24	18	10	21	12	18	18	17	21
7:00 PM	23	19	7	21	10	17	19	17	21
7:15 PM	18	21	10	16	11	18	20	16	20
7:30 PM	23	21	12	7	7	19	17	15	21
7:45 PM	24	19	7	17	6	20	16	16	20
8:00 PM	23	18	15	16	8	21	10	16	21
8:15 PM	17	17	12	17	6	19	17	15	17
8:30 PM	16	17	10	15	9	19	15	14	17
PEAK	24	23	16	23	15	22	20	20	23

Source: Queue observations at existing In-N-Out restaurants; see Attachment B.

Table 2
Weekend Drive Through Queue Survey Summary

Time	Peak Queue Observed within 15-Minute Increment								
	Corona	Highland	Indio	La Quinta	Long Beach	Los Angeles	Thousand Palms	Average	85th-%ile
LUNCH									
11:00 AM	9	9	6	8	7	8	8	8	9
11:15 AM	13	14	4	11	8	11	8	10	13
11:30 AM	17	16	7	16	9	12	12	13	16
11:45 AM	19	18	8	11	16	18	14	15	18
12:00 PM	17	18	11	10	16	20	11	15	18
12:15 PM	18	20	8	14	14	16	12	15	18
12:30 PM	23	20	9	18	16	20	18	18	20
12:45 PM	24	21	11	16	10	20	16	17	21
1:00 PM	24	19	16	15	15	23	15	18	23
1:15 PM	23	20	7	14	16	22	15	17	22
1:30 PM	24	20	6	18	10	20	18	17	20
1:45 PM	23	22	8	15	9	20	18	16	22
2:00 PM	22	17	12	16	12	21	14	16	21
DINNER									
4:00 PM	20	14	10	14	8	10	12	13	15
4:15 PM	18	15	15	17	10	14	11	14	17
4:30 PM	17	16	15	17	8	18	12	15	17
4:45 PM	17	18	16	20	5	8	11	14	18
5:00 PM	23	19	20	21	9	8	12	16	21
5:15 PM	24	20	22	18	10	9	11	16	22
5:30 PM	24	22	22	19	10	20	6	18	22
5:45 PM	23	18	24	12	9	19	16	17	23
6:00 PM	24	23	21	11	13	20	19	19	23
6:15 PM	24	21	16	10	9	19	17	17	21
6:30 PM	25	20	10	17	10	20	15	17	21
6:45 PM	25	19	11	18	14	18	20	18	21
7:00 PM	24	21	8	10	12	19	19	16	21
7:15 PM	24	19	7	12	13	20	13	15	20
7:30 PM	23	18	6	11	9	21	12	14	21
7:45 PM	23	19	9	8	9	22	14	15	22
8:00 PM	15	20	12	15	10	21	13	15	20
8:15 PM	16	19	9	16	9	22	17	15	19
8:30 PM	17	21	8	16	11	18	17	15	18
PEAK	25	23	24	21	16	23	20	22	24

Source: Queue observations at existing In-N-Out restaurants; see Attachment B.

Attachment A

Site Plan

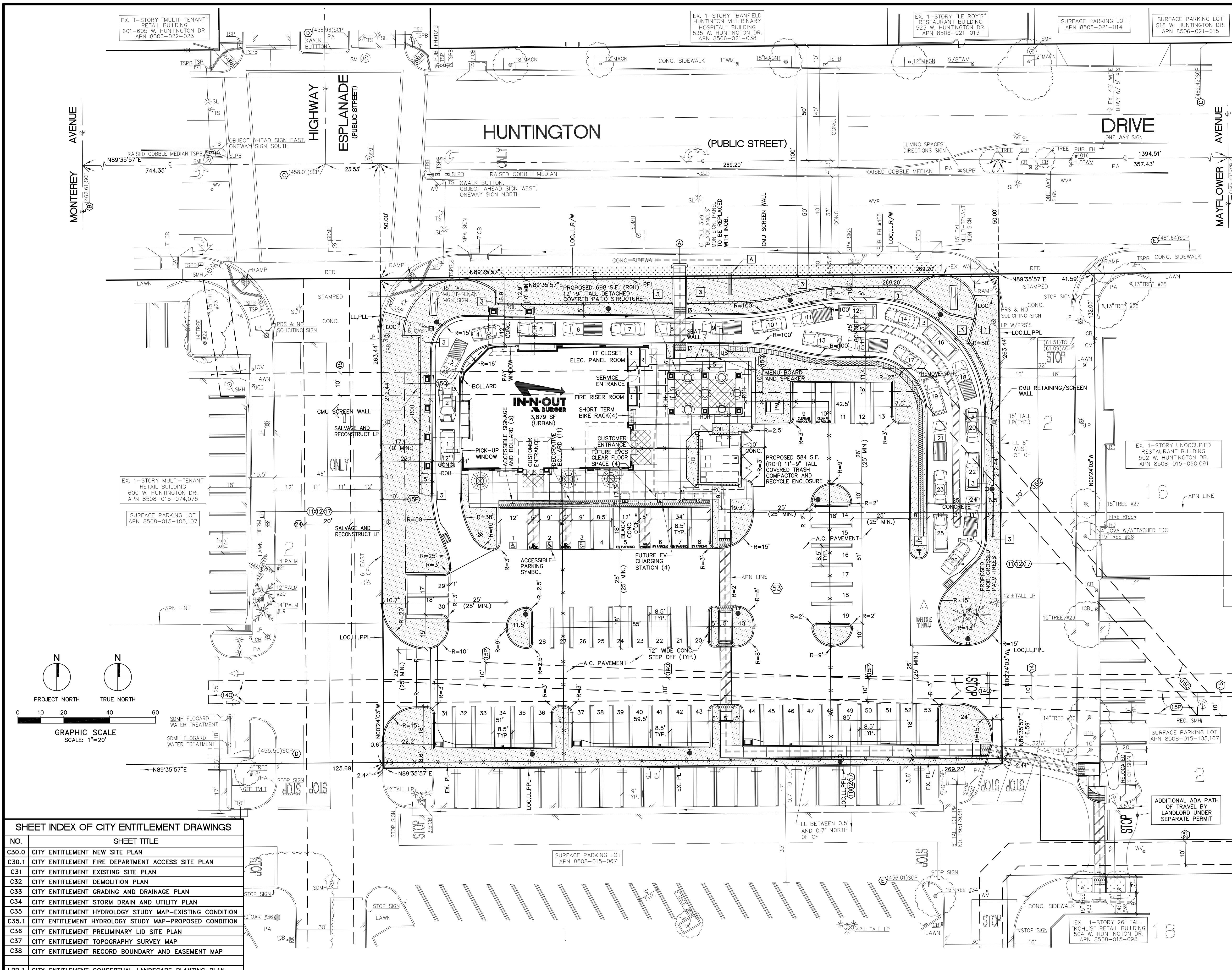

- ### LEGEND
- NEW 24"x36" CONCRETE DRAIN BOX INLET WITH A FLOARD PLUS FOSSIL FILTER INSERT FOR THE PRE-TREATMENT OF STORMWATER RUNOFF
 - PROPOSED INOB INSTALLED AND MAINTAINED 22'-6" TALL FIXTURE HEIGHT LIGHT POLE ON TOP OF A 30" TALL 24" DIAMETER CONCRETE BASE FOR A TOTAL HEIGHT OF 25' TALL MAXIMUM
 - PROPOSED INOB INSTALLED AND MAINTAINED DROUGHT TOLERANT LANDSCAPED PLANTER AND IRRIGATION SYSTEM ONSITE, INCLUDING AREA UNDER BUILDING ROOF OVERHANG (ROH), CONSISTING OF APPROXIMATELY 12,690 SQUARE FEET (22.4%)
 - BLACK TRUNCATED DOMES DETECTABLE WALKING STRIP
 - VEHICLE DETECTOR LOOP
 - PROPERTY LINE
 - OUTDOOR SEATING PATIO TABLE WITH AN UMBRELLA (4 SEATS)
 - OUTDOOR SEATING PATIO TABLE WITH NO UMBRELLA (4 SEATS)
 - NEW 3" TALL 18"x24" LIT "DRIVE THRU" DIRECTIONAL SIGN
 - NEW 3" TALL 18"x24" LIT "THANK YOU, DO NOT ENTER" DIRECTIONAL SIGN
 - NEW PEDESTRIAN CROSSWALK SIGN
 - NEW ACCESSIBILITY ENTRY SIGN
 - INOB IN-N-OUT BURGER
 - LL INOB LEASE PREMISES LINE
 - CF CURB FACE
 - PPL PROPOSED LOTS 1,2 AND 7 PROPERTY LINES BY 2 NEW LOT LINE ADJUSTMENTS
 - EXISTING 10' WIDE CITY SEWER EASEMENT TO BE QUITCLAIMED
 - PROPOSED 10' WIDE CITY SEWER EASEMENT
 - EXPOSED HEIGHT OF CMU RETAINING WALL IN FEET
 - TSF TUBE STEEL FENCE
 - PROPOSED 18" TO 27" TALL 22" WIDE STUCCO COVERED SEAT/SCREEN WALL WITH A PRECAST CONCRETE CAP.
 - LOC INOB LIMITS OF PROPOSED CONSTRUCTION
 - VOL 2' VEHICLE OVERHANG WITH NO OBSTRUCTIONS INCLUDING LIGHT POLES, TREES AND SIGNAGE
 - ADA ACCESSIBLE PATH OF TRAVEL ACCESSIBLE PATH OF TRAVEL IS NOT LESS THAN 4 FEET WIDE, AND DOES NOT EXCEED A RUNNING SLOPE OF 1:20 (5%) OR A CROSS SLOPE IN EXCESS OF 1:50 (2%). REFER TO SHEET C34 FOR SPECIFIC SLOPES AND GRADES.
 - SCE ELECTRIC PAD MOUNT TRANSFORMER WITH BOLLARDS
 - PORTABLE TRASH RECEPTACLE ON A MINIMUM 24"x24"x4" CONCRETE PAD
 - NEW CONCRETE SIDEWALK
 - BOUNDARY MONUMENT AND SURVEY CONTROL POINT DESCRIPTION SHOWN ON SHEET C38
 - SIMPLIFIED PLOTTABLE EASEMENT DESCRIPTION SHOWN ON SHEET C38
 - DRIVE-THRU CATWALK CONCRETE PAD WITH UMBRELLA STAND.
 - FUTURE EV (ELECTRIC VEHICLE) CHARGEPOINT EXPRESS 250 CHARGING STATION (OR EQUIVALENT), PROPOSED 4" DIAMETER ELECTRIC PULL BOX AND CLEAR FLOOR SPACE
 - 24" WIDE MATTED INOB ASSOCIATE WALKWAY CONSISTING OF APPROXIMATELY 301 SQUARE FEET
 - PROPOSED INOB INSTALLED AND MAINTAINED DROUGHT TOLERANT LANDSCAPED PLANTER AND IRRIGATION SYSTEM OFFSITE IN AND ADJOINING HUNTINGTON DRIVE CONSISTING OF APPROXIMATELY 1,123 SQUARE FEET
 - EXISTING LOT 7 PROPERTY LINE TO BE REMOVED
 - EXISTING 10' WIDE GTE TELEPHONE EASEMENT TO BE QUITCLAIMED
 - PROPOSED LANDLORD INSTALLED AND LANDLORD MAINTAINED LANDSCAPED PLANTER AND IRRIGATION SYSTEM OFFSITE WITHIN THE HUNTINGTON OAKS CENTER ADJACENT TO KOHL'S CONSISTING OF APPROXIMATELY 120 SQUARE FEET
 - CMU SPLIT FACE BLOCK SCREEN WALL TO MATCH EXISTING
 - 8" WIDE CONCRETE CURB WITH A 42" TALL TSF ON TOP
 - INSTALL WARNING LIGHTS ON THE GROUND AT A POINT WHERE THE ONSITE CONCRETE ADA PATH OF TRAVEL SIDEWALK MEETS THE HUNTINGTON DRIVE PUBLIC SIDEWALK ALONG WITH A "DO NOT BLOCK" SIGN TO THE SATISFACTION OF THE LANDLORD ("FESTIVAL") AND THE CITY.

- ### GENERAL NOTES
- IN-N-OUT BURGER LEASE PREMISES AREA = 56,532 SQ. FT. OR 1,298 ACRES.
 - EXISTING CITY ZONE: REGIONAL/SUBREGIONAL COMMERCIAL.
 - GENERAL PLAN LAND USE DESIGNATION: REGIONAL/SUBREGIONAL COMMERCIAL.
 - EXISTING LAND USE: 10,927 SQUARE FOOT ONE STORY FORMER BLACK ANGUS RESTAURANT BUILDING WITH 85 PAVED STRIPED PARKING SPACES.
PROPOSED LAND USE: NEW IN-N-OUT BURGER SIT DOWN RESTAURANT WITH A DRIVE-THRU LANE PERMITTED IN CITY ZONE.
 - EXISTING BLACK ANGUS LOT 7 AREA = 16,694 S.F.
PROPOSED IN-N-OUT BURGER LOT 7 AREA = 57,458 S.F.
 - PROPOSED SCOPE OF WORK:
(A) CONSTRUCT A 3,879 SQUARE FOOT SIT-DOWN (84 SEATS INSIDE) RESTAURANT BUILDING AND A 28 VEHICLE LONG DRIVE THRU QUEUE.
 - IN-N-OUT BURGER URBAN BUILDING AREA = 3,879 S.F.
COVERED PATIO ROOF OVERHANG = 698 S.F.
COVERED TRASH ENCLOSURE ROOF OVERHANG = 584 S.F.
INDOOR SEATING = 84 SEATS, OUTDOOR SEATING = 40 SEATS (10 TABLES)
OUTDOOR SEATING AREA = 698 S.F. STRUCTURE PLUS 64 S.F. EACH FOR 3-4 SEAT TABLES (192 S.F.) PLUS 20 S.F. EACH FOR 0-2 SEAT TABLES (0 S.F.) = 890 S.F.
 - REQUIRED PARKING: 1.5 SPACES FOR EVERY INDOOR PLUS OUTDOOR TABLE OR MINIMUM OF 10 SPACES, WHICHEVER IS GREATER. INDOOR TABLES = 21 FOR 32 SPACES, OUTDOOR TABLES = 10 FOR 15 SPACES, FOR A TOTAL OF 47 SPACES.
 - MAXIMUM FLOOR AREA RATIO (FAR) = UNKNOWN. FAR PROVIDED = 0.07.
 - REQUIRED SITE LANDSCAPE AREA = UNKNOWN.
 - LANDSCAPE AREA PROVIDED WITHIN PROPERTY = 12,690 S.F. (22.4%).

IN-N-OUT BURGER PARKING SPACE DETAILED SUMMARY TABLE

DESCRIPTION	EXISTING	REQUIRED	PROPOSED
1. STANDARD SPACE (8.5'x18')	0	42	44
2. EXISTING STANDARD SPACE (SIZE VARIES)	83	0	0
3. ACCESSIBLE VAN SPACE (17'x18' PLUS A 2' VOH)	0	1	1
4. ACCESSIBLE SPACE (14'x18' PLUS A 2' VOH)	2	1	2
5. FUTURE EV VAN ACCESSIBLE SPACE (17'x18' PLUS A 2' VOH)	0	1	1
6. FUTURE EV PARKING SPACE (8.5'x18' PLUS A 2' VOH)	0	1	3
7. CLEAN AIR/VAN POOL/EV (8.5'x18')	0	1	2
8. TOTAL	85	47	53
9. IN-N-OUT BURGER DRIVE THRU VEHICLE QUEUE (20' LONG INOB VEHICLE)	0	0	26
10. SHORT-TERM BICYCLE PARKING WITHIN DESIGNATED BIKE RACK	0	0	4
11. LONG-TERM BICYCLE PARKING WITHIN A LOCKABLE PERMANENTLY ANCHORED LOCKER ON A CONCRETE SLAB-AMERICAN BICYCLE SECURITY COMPANY BIKE-SHELL MODEL 302, FINISH: MEDIUM GRAY	0	0	0

- ALL NEW SIGNS SHALL BE APPROVED BY A SEPARATE CITY PERMIT.
- ASSESSOR PARCEL NUMBER: 8508-015-076,077 AND A PORTION OF 8508-015-067 AND 105.
- EXISTING TREES ONSITE = 17
ONSITE TREES TO BE PROTECTED IN PLACE = 0
OFFSITE STREET TREES TO BE REMOVED = 0
TOTAL TREES TO BE REMOVED = 17
- EXISTING LANDSCAPE AREA ONSITE = 10,878 S.F. (18.9%).
- VEHICLE PARKING AND ACCESS IS RECIPROCAL WITH THE BALANCE OF THE CENTER.
- SITE PLAN SHALL MEET ALL ENGINEERING AND NPDES REQUIREMENTS.

ENCROACHMENT NOTES

A) NORTH EDGE OF A 6' TALL FORMER "BLACK ANGUS" 3' TALL BY 9' LONG SIGN PANEL ENROACHES 0.9' NORTH OF AND OUTSIDE OF THE SURVEYED PROPERTY INTO THE HUNTINGTON DRIVE PUBLIC STREET RIGHT OF WAY.

SHEET INDEX OF CITY ENTITLEMENT DRAWINGS

NO.	SHEET TITLE
C30.0	CITY ENTITLEMENT NEW SITE PLAN
C30.1	CITY ENTITLEMENT FIRE DEPARTMENT ACCESS SITE PLAN
C31	CITY ENTITLEMENT EXISTING SITE PLAN
C32	CITY ENTITLEMENT DEMOLITION PLAN
C33	CITY ENTITLEMENT GRADING AND DRAINAGE PLAN
C34	CITY ENTITLEMENT STORM DRAIN AND UTILITY PLAN
C35	CITY ENTITLEMENT HYDROLOGY STUDY MAP-EXISTING CONDITION
C35.1	CITY ENTITLEMENT HYDROLOGY STUDY MAP-PROPOSED CONDITION
C36	CITY ENTITLEMENT PRELIMINARY LID SITE PLAN
C37	CITY ENTITLEMENT TOPOGRAPHY SURVEY MAP
C38	CITY ENTITLEMENT RECORD BOUNDARY AND EASEMENT MAP
LPP.1	CITY ENTITLEMENT CONCEPTUAL LANDSCAPE PLANTING PLAN

DEVELOPER:
IN-N-OUT BURGER
13502 HAMBURGER LANE
BALDWIN PARK, CA 91706
CONTACT: MARC LEVUN
PHONE: 626 813-5378

Underground Service Alert
Call: Toll Free
811
TWO WORKING DAYS BEFORE YOU DIG

REVISIONS

△	
△	
△	
△	

GHA PROJECT NO. _____

Architecture/Development
14901 Quorum Drive
Suite 300
Dallas Texas 75254
Ph: (972) 239-8884
Fax: (972) 239-5054

CIVIL ENGINEER:
MSI ENGINEERING, INC.
CIVIL ENGINEERS AND LAND SURVEYORS SPECIALIZING IN SITE DEVELOPMENT
301 NORTH SAN DIMAS AVENUE, SAN DIMAS, CA. 91773
(909) 305-2395 FAX (909) 305-2397

Mark S. Lamoureux
MARK S. LA MOUREUX
R.C.E. 38382
12-14-2021 DATE

IN-N-OUT BURGER

HUNTINGTON OAKS
CENTER PAD "D"
560 WEST HUNTINGTON DRIVE
MONROVIA, CA 91016

CITY ENTITLEMENT

NEW SITE PLAN

C30.0

Attachment B
Queue Survey Data

Corona
(2305 Compton Ave, Corona, CA 92881)

Time	Corona In-N-Out							Peak
	Saturday	Sunday	Monday	Tuesday	Wednesday	Thursday	Friday	
	12/2/2017	12/3/2017	12/4/2017	12/5/2017	12/6/2017	12/7/2017	12/8/2017	
10:30-10:45	7	5	6	5	6	5	6	7
10:45-11:00	14	11	14	7	12	7	8	14
11:00-11:15	7	9	17	11	12	9	10	17
11:15-11:30	9	13	14	15	12	11	17	17
11:30-11:45	9	17	14	15	15	16	16	17
11:45-12:00	11	19	17	10	14	16	15	19
12:00-12:15	13	17	12	13	18	15	23	23
12:15-12:30	16	18	17	13	18	14	24	24
12:30-12:45	20	23	20	13	16	13	23	23
12:45-1:00	22	24	15	17	13	14	17	24
1:00-1:15	22	24	14	11	13	16	14	24
1:15-1:30	23	23	11	14	16	18	15	23
1:30-1:45	24	22	11	11	15	17	16	24
1:45-2:00	23	17	10	10	13	14	15	23
2:00-2:15	22	18	15	11	16	10	15	22
2:15-2:30	23	17	17	16	16	13	13	23
2:30-2:45	24	23	18	15	12	13	13	24
2:45-3:00	20	14	12	14	10	13	15	20
3:00-3:15	20	18	18	23	17	14	16	23
3:15-3:30	17	14	15	19	18	14	18	19
3:30-3:45	17	16	18	17	11	16	17	18
3:45-4:00	15	17	16	12	15	14	15	17
4:00-4:15	18	20	12	9	12	15	17	20
4:15-4:30	16	18	16	10	9	11	11	18
4:30-4:45	16	17	17	14	10	9	11	17
4:45-5:00	16	17	14	12	16	15	13	17
5:00-5:15	23	15	16	13	23	18	13	23
5:15-5:30	24	17	23	12	18	21	16	24
5:30-5:45	24	23	16	13	16	16	23	24
5:45-6:00	23	23	15	13	17	18	15	23
6:00-6:15	18	24	12	12	18	23	19	24
6:15-6:30	23	24	15	17	23	24	17	24
6:30-6:45	23	25	23	23	23	24	18	25
6:45-7:00	20	25	24	17	17	23	15	25
7:00-7:15	23	24	23	18	14	13	17	24
7:15-7:30	15	24	16	15	16	17	18	24
7:30-7:45	14	23	12	14	13	16	23	23
7:45-8:00	16	23	14	12	13	20	24	24
8:00-8:15	15	15	14	12	14	17	23	23
8:15-8:30	16	15	15	13	12	14	17	17
8:30-8:45	17	16	14	14	10	15	16	17
8:45-9:00	14	14	14	10	14	15	13	15
9:00-9:15	17	12	14	12	11	13	15	17
9:15-9:30	12	10	15	9	11	15	15	15
9:30-9:45	16	13	11	8	8	10	16	16
9:45-10:00	12	15	9	8	11	13	11	15
10:00-10:15	13	12	14	7	12	13	12	14
10:15-10:30	12	9	9	6	11	13	15	15
10:30-10:45	14	13	11	6	7	11	15	15
10:45-11:00	19	11	9	7	8	9	14	19
11:00-11:15	20	8	8	6	6	8	13	20
11:15-11:30	16	12	6	5	5	7	11	16
11:30-11:45	14	10	7	4	4	5	11	14
11:45-12:00	12	8	5	4	5	6	11	12
12:00-12:15	11	5	5	3	4	4	11	11
12:15-12:30	11	7	4	3	3	3	11	11
12:30-12:45	13	6	3	3	2	3	11	13
12:45-1:00	13	4	2	2	2	2	11	13
Day Peak	24	25	24	23	23	24	24	25

Highland
(28009 Greenspot Rd, Highland, CA 92346)

Time	Highland In-N-Out							Peak
	Saturday	Sunday	Monday	Tuesday	Wednesday	Thursday	Friday	
	12/2/2017	12/3/2017	12/4/2017	12/5/2017	12/6/2017	12/7/2017	12/8/2017	
10:30-10:45	4	6	6	5	4	4	6	6
10:45-11:00	5	7	8	7	6	7	11	11
11:00-11:15	6	9	11	9	9	10	14	14
11:15-11:30	14	11	17	10	13	14	15	17
11:30-11:45	12	16	15	14	15	14	16	16
11:45-12:00	13	18	14	14	14	14	17	18
12:00-12:15	16	18	18	17	14	18	19	19
12:15-12:30	20	20	17	17	15	18	21	21
12:30-12:45	20	20	16	19	15	17	21	21
12:45-1:00	21	19	13	18	11	18	20	21
1:00-1:15	18	19	14	17	7	18	19	19
1:15-1:30	20	19	11	13	10	14	14	20
1:30-1:45	20	18	14	13	10	13	16	20
1:45-2:00	22	17	14	18	3	13	18	22
2:00-2:15	17	15	13	15	14	16	17	17
2:15-2:30	17	17	18	16	15	19	18	19
2:30-2:45	14	18	14	13	14	16	15	18
2:45-3:00	17	15	15	12	13	18	15	18
3:00-3:15	16	16	18	14	12	16	18	18
3:15-3:30	18	19	18	12	13	14	18	19
3:30-3:45	14	19	17	10	17	19	19	19
3:45-4:00	12	16	18	11	16	18	17	18
4:00-4:15	14	14	15	14	14	15	13	15
4:15-4:30	15	14	13	16	12	16	19	19
4:30-4:45	14	16	15	14	15	14	17	17
4:45-5:00	15	18	18	15	14	17	16	18
5:00-5:15	15	19	15	14	13	19	15	19
5:15-5:30	18	20	13	13	17	19	19	20
5:30-5:45	22	19	16	19	16	18	19	22
5:45-6:00	17	18	20	19	18	21	20	21
6:00-6:15	23	21	20	18	20	21	23	23
6:15-6:30	19	21	19	17	13	19	22	22
6:30-6:45	19	20	19	17	16	18	17	20
6:45-7:00	19	19	18	15	14	17	18	19
7:00-7:15	21	17	16	14	13	16	19	21
7:15-7:30	19	18	15	15	15	21	20	21
7:30-7:45	17	18	12	16	12	19	21	21
7:45-8:00	15	19	15	17	17	19	19	19
8:00-8:15	18	20	18	13	18	14	18	20
8:15-8:30	19	17	13	16	16	14	17	19
8:30-8:45	21	15	13	13	17	12	17	21
8:45-9:00	19	14	12	13	19	14	15	19
9:00-9:15	20	16	11	14	18	15	18	20
9:15-9:30	20	16	14	15	16	19	17	20
9:30-9:45	18	17	15	12	14	18	16	18
9:45-10:00	17	16	12	11	12	16	16	17
10:00-10:15	20	13	10	10	13	15	14	20
10:15-10:30	19	12	9	10	15	14	14	19
10:30-10:45	18	12	8	8	14	11	14	18
10:45-11:00	18	13	7	7	10	11	14	18
11:00-11:15	15	15	8	7	11	10	11	15
11:15-11:30	17	16	7	8	9	9	12	17
11:30-11:45	19	12	6	6	7	8	10	19
11:45-12:00	16	9	5	5	8	9	9	16
12:00-12:15	16	8	5	6	6	7	8	16
12:15-12:30	15	7	4	4	5	5	7	15
12:30-12:45	9	5	3	3	3	4	3	9
12:45-1:00	8	4	2	2	2	2	5	8
Day Peak	23	21	20	19	20	21	23	23

Indio
(82043 Highway 111, Indio, CA 92201)

La Quinta
(78611 Highway 111, La Quinta, CA 92253)

Long Beach
(6391 E Pacific Coast Highway, Long Beach, CA 90803)

AM Period	IN	OUT	MAXIMUM QUEUE	PM Period	IN	OUT	MAXIMUM QUEUE		
00:00				12:00	31	25	15		
00:15				12:15	30	15	15		
00:30				12:30	52	50	13		
00:45				12:45	25	138	29	119	8
01:00				13:00	29	29	12		
01:15				13:15	32	27	13		
01:30				13:30	18	23	8		
01:45				13:45	X	79	X	79	7
02:00				14:00			8		
02:15				14:15			7		
02:30				14:30			8		
02:45				14:45			6		
03:00				15:00			6		
03:15				15:15			5		
03:30				15:30			4		
03:45				15:45			5		
04:00				16:00	16	19	6		
04:15				16:15	12	17	5		
04:30				16:30	14	14	3		
04:45				16:45	16	58	10	60	6
05:00				17:00	19	14	5		
05:15				17:15	20	19	7		
05:30				17:30	19	19	7		
05:45				17:45	11	69	21	73	5
06:00				18:00	17	20	12		
06:15				18:15	X	X	7		
06:30				18:30	X	X	10		
06:45				18:45	X	17	X	20	12
07:00				19:00			10		
07:15				19:15			11		
07:30				19:30			7		
07:45				19:45			6		
08:00				20:00			8		
08:15				20:15			6		
08:30				20:30			9		
08:45				20:45			10		
09:00				21:00			12		
09:15				21:15			16		
09:30				21:30			14		
09:45				21:45			15		
10:00				22:00			14		
10:15			5	22:15			13		
10:30			8	22:30			12		
10:45			7	22:45			12		
11:00			3	23:00			11		
11:15			6	23:15			13		
11:30	19	25	7	23:30			9		
11:45	21	40	27	52	14	23:45	8		
Total Vol.	40	52				361	351		

Daily Total
IN 401
OUT 361

PACIFIC TRAFFIC & TRANSIT DATA SERVICES

Saturday, May 19, 2012

CITY: Long Beach

PROJECT: In N Out Burger

AM Period	IN	OUT	MAXIMUM QUEUE	PM Period	IN	OUT	MAXIMUM QUEUE		
00:00				12:00	17	17	16		
00:15				12:15	34	20	14		
00:30				12:30	22	30	16		
00:45				12:45	32	105	37	104	10
01:00				13:00	33	27	15		
01:15				13:15	29	23	16		
01:30				13:30	29	33	10		
01:45				13:45	X	91	X	83	9
02:00				14:00			12		
02:15				14:15			13		
02:30				14:30			9		
02:45				14:45			8		
03:00				15:00			9		
03:15				15:15			9		
03:30				15:30			6		
03:45				15:45			9		
04:00				16:00	21	25	8		
04:15				16:15	22	16	10		
04:30				16:30	21	25	8		
04:45				16:45	24	88	24	90	5
05:00				17:00	19	19	9		
05:15				17:15	19	21	10		
05:30				17:30	28	25	10		
05:45				17:45	18	84	19	84	9
06:00				18:00	23	18	13		
06:15				18:15			9		
06:30				18:30			10		
06:45				18:45	X	23	X	18	14
07:00				19:00			12		
07:15				19:15			13		
07:30				19:30			9		
07:45				19:45			9		
08:00				20:00			10		
08:15				20:15			9		
08:30				20:30			11		
08:45				20:45			12		
09:00				21:00			13		
09:15				21:15			17		
09:30				21:30			15		
09:45				21:45			10		
10:00				22:00			12		
10:15			4	22:15			14		
10:30			7	22:30			13		
10:45			9	22:45			11		
11:00			7	23:00			9		
11:15			8	23:15			10		
11:30	25	16	9	23:30			8		
11:45	27	52	18	34	16	23:45	6		
Total Vol.	52	34					391	379	

Daily Total	
IN	443
OUT	391

PACIFIC TRAFFIC & TRANSIT DATA SERVICES

Los Angeles
(9149 S Sepulveda Blvd, Los Angeles, CA 90045)

05.16.2012

Wednesday, May 16th, 2012

CITY: Los Angeles

PROJECT: In-N-Out Burger

AM Period	IN	OUT	MAXIMUM QUEUE	PM Period	IN	OUT	MAXIMUM QUEUE
00:00				12:00	39	35	20
00:15				12:15	48	36	18
00:30				12:30	52	37	21
00:45				12:45	57	41	19
					196	149	
01:00				13:00	39	45	22
01:15				13:15	36	46	21
01:30				13:30	35	41	20
01:45				13:45	X	X	20
					110	132	
02:00				14:00			21
02:15				14:15			21
02:30				14:30			22
02:45				14:45			21
03:00				15:00			18
03:15				15:15			17
03:30				15:30			16
03:45				15:45			18
04:00				16:00	31	24	17
04:15				16:15	18	18	15
04:30				16:30	27	28	12
04:45				16:45	33	22	10
					109	92	
05:00				17:00	34	30	9
05:15				17:15	25	33	14
05:30				17:30	36	23	17
05:45				17:45	32	25	19
					127	111	
06:00				18:00	30	36	20
06:15				18:15			19
06:30				18:30			20
06:45				18:45			18
07:00				19:00			17
07:15				19:15			18
07:30				19:30			19
07:45				19:45			20
08:00				20:00			21
08:15				20:15			19
08:30				20:30			19
08:45				20:45			20
09:00				21:00			18
09:15				21:15			19
09:30				21:30			20
09:45				21:45			19
10:00			0	22:00			21
10:15			2	22:15			17
10:30			5	22:30			16
10:45			6	22:45			14
11:00			6	23:00			16
11:15			12	23:15			17
11:30	28	32	16	23:30			15
11:45	31	59	29	23:45	61	120	19
							23:45
Total Vol.	59	61				542	484

Daily Totals		
IN		OUT
601		545

PACIFIC TRAFFIC & TRANSIT DATA SERVICES

05/19/12		CITY: Los Angeles				PROJECT: In-N-Out Burger			
AM Period	IN	OUT	MAXIMUM QUEUE	PM Period	IN	OUT	MAXIMUM QUEUE		
00:00				12:00	49	38			20
00:15				12:15	49	41			16
00:30				12:30	51	43			20
00:45				12:45	66	215	57	179	20
01:00				13:00	53	49			23
01:15				13:15	54	51			22
01:30				13:30	49	54			20
01:45				13:45	X	156	X	154	20
02:00				14:00					21
02:15				14:15					26
02:30				14:30					22
02:45				14:45					21
03:00				15:00					18
03:15				15:15					17
03:30				15:30					17
03:45				15:45					9
04:00				16:00	28	24			10
04:15				16:15	37	20			14
04:30				16:30	38	25			18
04:45				16:45	25	128	34	103	8
05:00				17:00	15	26			8
05:15				17:15	28	30			9
05:30				17:30	43	24			20
05:45				17:45	33	119	33	113	19
06:00				18:00	35	38			20
06:15				18:15	X	X			19
06:30				18:30	X	X			20
06:45				18:45	X	35	X	38	18
07:00				19:00					19
07:15				19:15					20
07:30				19:30					21
07:45				19:45					22
08:00				20:00					21
08:15				20:15					22
08:30				20:30					18
08:45				20:45					17
09:00				21:00					16
09:15				21:15					19
09:30				21:30					18
09:45				21:45					20
10:00				22:00					19
10:15			3	22:15					18
10:30			4	22:30					19
10:45			6	22:45					18
11:00			8	23:00					21
11:15			11	23:15					17
11:30	31	46	12	23:30					16
11:45	42	73	35	23:45	81				14
Total Vol.	73	81				653	587		

Daily Totals	
IN	OUT
726	668

PACIFIC TRAFFIC & TRANSIT DATA SERVICES

Thousand Palms
(72265 Varner Rd, Thousand Palms, CA 92276)

